

Product leaflet

Product
Face shield

Model No.
SR 540

Ordering No.
H06-0512

Product Description

The SR 540 face shield together with the battery-powered SR 500 or SR 700 fan and approved filters are included in the Sundström fan-assisted respiratory protection device systems. The breathing hose of the face shield is to be connected to the fan, equipped with filters. The pressure generated in the face shield prevents particles and other pollutants from entering the hood.

The SR 540 can also be used with the SR 507 compressed air equipment. This combination forms a breathing apparatus designed for continuous air flow, for connection to a compressed air supply.

The equipment can be used as an alternative to filter respirators in all situations for which filter respirators are recommended. This applies particularly to work that is hard, warm or of long duration.

The characteristics of the SR 540 face shield are as follows:

Protects the breathing zone and the crown of the head • Hinged visor unit • Scratch resistant and chemicals resistant PC visor • The supply air flow keeps the visor demisted • Adjustable head harness • Replaceable breathing air hose • Equipped with an exhalation valve • Optional PETG visor, peel-offs and head-cover • Available in one size.

The SR 540 is also available in an explosion-protected version designated the SR 540 EX for use in a potentially explosive atmosphere (ATEX Directive 94/9/EC). See the separate product leaflet.

Technical specification

	SR 540/SR 500/SR 700	EN 12941:1998 + A2:2008	SR 540/SR 507	EN 14594:2005
Working pressure	-	-	5–7 bar	≤ 10 bar
Air flow rate	175-240 l/min (SR 500) 175-225 l/min (SR 700)	≥ 120 l/min	175–260 l/min	-
Service temperature	-10 – +55°C, < 90 % RH	-	-10 – +55°C, < 90 % RH	-
Storage temperature	-20 – +40°C, < 90 % RH	-	-20 – +40°C, < 90 % RH	-
Low flow warning level	< 175 l/min	≤ 175 l/min	< 175 g	≤ 175 l/min
Weight with breathing hose	≈ 700 g	≤ 1,500 g	≈ 700 g	≤ 1,500 g
Impact test with 6 mm dia. steel ball against visor	120 m/s	-	120 m/s	-
Assigned Protection Factor¹	40 (TH3)	-	40 (3A,3B)	-
Nominal Protection Factor²	500 (TH3)	-	200 (3A,3B)	-
Approvals	EN 12941:1998 + A2:2008	-	EN 14594:2005 3A, 3B	-

1) Specified in BS 4275 and applies regardless of the test results.

2) According to EN 529:2005.

- A. SR 540
- B. SR 507
- C. SR 500
- D. SR 700

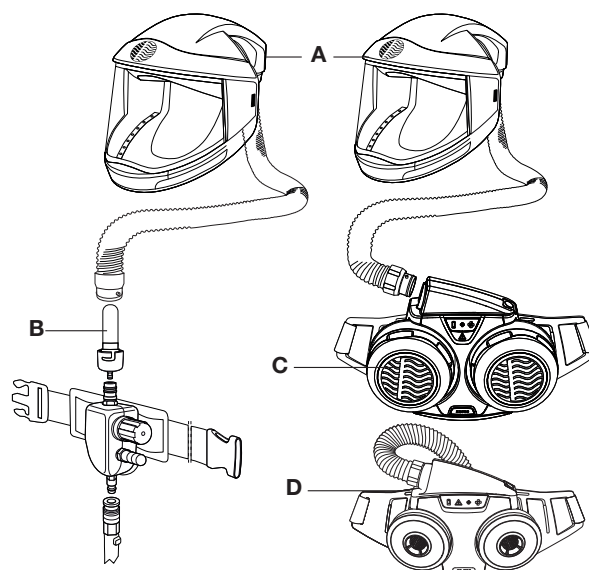

Head Office
Tel: +46 10 484 87 00

Visiting address:
Stockholmsvägen 33
SE-181 33 Lidingö

Factory
Tel: +46 10 484 87 00

Visiting address:
Västergatan 4
SE-341 50 Lagan

Sundström
www.srsafety.com